

# winfit<sup>2</sup>

- 
1. Former
  2. Fixer
  3. Cavity closer
- Three solutions, one system

## Make fitting windows as easy as 1, 2, 3

The complete window former,  
fixer and cavity closer system



Exceeds Document L  
requirements

# The former, fixer and cavity closer

Winfit2 is the simplest, quickest window installation system on the market. Designed by the people who introduced PVC-U windows to new build a decade ago, Winfit2 is complete: a former, fixer and cavity closer in one system.

Since it was launched in 1995, Winfit2 has been used to fit hundreds of thousands of windows into new build properties. The reason is simple: it does the job. With Winfit2, windows can be fitted in six simple steps – and window frames only have to be installed after all other building work is complete.

## Winfit2 at a glance

- BBA approved – certificate no. 01/3827
- Foam insert for even better thermal efficiency
- Meets Document L requirements – with or without foam insert
- Integral overhead ventilation system
- Suits any window material – including timber



## Product Range

### 50mm profiles

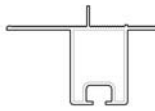

BBA Recommended Position  
(Cill position B)



In-Check (Jamb) Position



In-Check (Cill) Position

### 65mm profiles

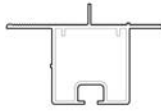

BBA Recommended Position  
(Cill position B)

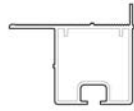

In-Check (Jamb) Position

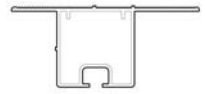

In-Check (Cill) Position



Cill Clip



Sub-frame Brick Tie

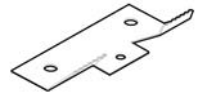

Jamb Clip

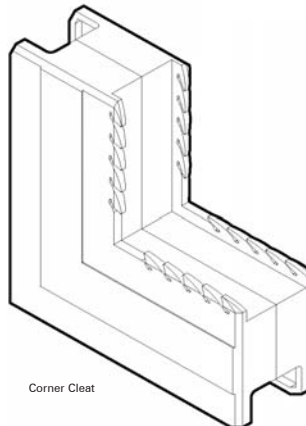

Corner Cleat

# ser: three solutions, one system

## 75mm profiles

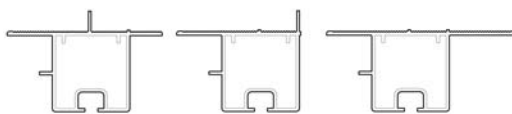

BBA Recommended Position  
(Cill position B)

In-Check (Jamb) Position

In-Check (Cill) Position

## 100mm profiles

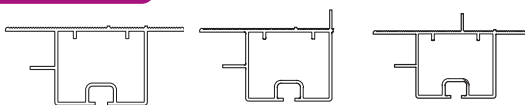

BBA Recommended Position  
(Cill position B)

In-Check (Jamb) Position

In-Check (Cill) Position  
(80mm available as above,  
but with side leg removed)

## Key product features

- 50, 65, 75, 80 and 100mm subframe profiles from stock
- Window acceptor – just clip frames in place
- Subframe can be welded or mechanically jointed using corner cleat
- Cavity brick ties to suit all cavity widths
- PVC-U top bracing system
- Jamb clips for clipping window into place

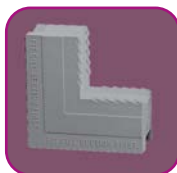

**NEW**

**Readymade service  
now available.**

**Call 01952 292511**

# Eight Simple Steps

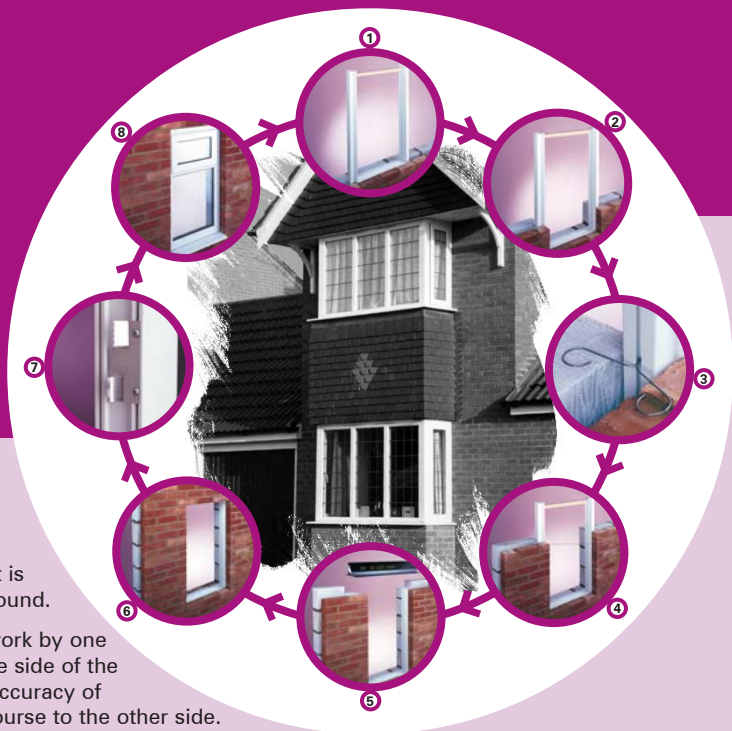

1. Build the inner and outer course of the cavity wall up to cill level and locate sub-frame in the cavity in the desired position, ensuring it is installed the correct way around.
2. Build up the outer course work by one course and butt to one side of the sub-frame. After checking accuracy of position, build up by one course to the other side.
3. Insert sub-frame ties into the profile chamber at every course of block work (every 3 bricks), tying both inner and outer courses. A minimum of 3 ties per vertical are required for the average 1200mm window.
4. The mortar and course work for inner and outer course can then be built up with normal techniques, remembering to insert ties.
5. Continue to check periodically that the sub-frame is vertical and build inner and outer course work up to lintel bedding height. Set lintel in position.
6. Continue building work until you are ready to fit your window
7. Fix a minimum of two jamb clips to the outer frame jamb (we recommend a trial build to confirm positioning) and apply a bead of silicone to the up-stand on the winfit sub-frame.
8. Simply clip the glazed window into place, applying even pressure and check the window is operational. Externally seal the window perimeter to the brickwork with silicone sealant.

For detailed fitting instructions, ask for a copy of the Winfit2 installation guide.

**winfit<sup>2</sup>**



Plaslyne, Unit D, Stafford Park 7, Telford TF3 3BQ.

Tel: 01952 292511 Fax: 01952 292025 Email: info@plaslyne.co.uk